



HYDRAULIC ROCK BREAKER
XL1000



NITROGEN
TECHNOLOGY
AT ITS BEST

BENEFITS

DESIGNED FOR 11 TO
17 TONNES CARRIERS

REDUCED COSTS,
UNCOMPROMISED
QUALITY

DESIGNED AND
PRODUCED
IN FRANCE

- High performance seals: nitrogen pressure remains stable over time, avoiding time consuming controls and recharges.
- Standard essentials: blank firing protection, energy recovery system, reinforced housing, full range of working tools.
- As green as others: designed and manufactured by Montabert, with the brand usual standards.

HYDRAULIC ROCK BREAKER

NITROGEN TECHNOLOGY AT ITS BEST

WEIGHT & DIMENSIONS

WEIGHT (KG/LB)

BREAKER	760	1,680
+ MOUNTED TOOL	828	1,826
+ MOUNTED ADAPTER PLATE (MAX)	1,006	2,218

DIMENSIONS (MM/IN)

A	1,481	58.3
B	2,018	79.5
C	340	13.4
D	109	16.1
E	51	2

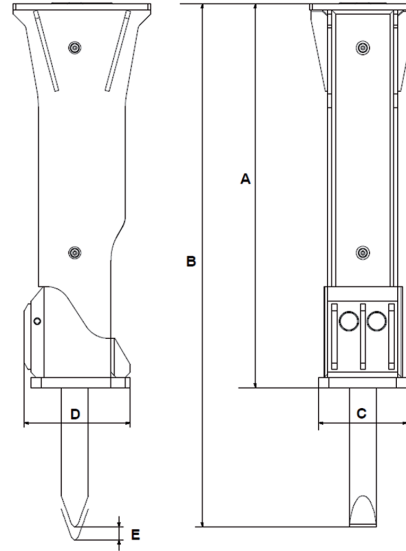

OPERATING INFORMATION

CARRIER WEIGHT RANGE (MIN-MAX, MT)	11-17	
OIL FLOW (MIN-MAX, L/MIN / GPM)	70-120	18.5-32
MAXIMUM OPERATING PRESSURE (BAR/PSI)	170	2,466
MAXIMUM BACK PRESSURE (BAR/PSI)	20	290
INPUT POWER (KW)	34	
STRIKING FREQUENCY (BPM)	400-750	
NOISE LEVEL /10M (DBA)	91	
AUTOMATIC LUBRICATION	option	
SOUNDPROOFING	standard	
INSPECTION KIT	standard	
PRESSURIZATION	preinstalled	

CONSUMABLES

CONSUMABLES	CPN
GREASE CARTRIDGES (X20)	86784758
ABL2 GREASE BUCKET (24 KG)	86772969
ABLF GREASE BUCKET (24 KG)	86772977

OPTIONS

OPTIONS	CPN
PRESSURIZATION KIT	86766870
ADAPTER PLATE	upon request
SPECIAL PAINTING	upon request

MAINTENANCE KITS

MAINTENANCE KITS	CPN
BASIC	86731775

TOOLS

TOOLS	CPN	CPN	CPN	CPN
DIAMETER (MM/IN)	106/4.17	106/4.17	106/4.17	106/4.17
LENGTH (MM/IN)	1,005/39.56	1,005/39.56	1,005/39.56	1,005/39.56
WEIGHT (KG/LB)	62/137	63/139	66/146	62/137
CPN	86722451	86722154	86722444	86622469



The content of this brochure constitutes non-binding information and may be changed at any time without notice. Montabert gives, and the brochure contains, no warranties whatsoever, express or implied. All the contents, including but not limited to text, images, graphics are all subject to copyright and all intellectual property protection. Their use or misuse is strictly prohibited. Montabert, KMC or Komatsu trademarks used herein are the property of their respective companies. Nothing contained on this document shall be construed as constituting any commitment by Montabert or as granting any license or right to use any intellectual property. ©2019 Montabert. All rights reserved.

montabert.com

